



PROVIDENCE

MAINTENANCE PLAN

WEEKLY/ MONTHLY MAINTENANCE - These are high use and high visibility areas to be maintained by the Master Home Owners Association during the growing season and as needed in the non-growing season. Those areas closest to the roadways and pedestrian trail will be maintained weekly. Some areas planted with wild flowers will receive less maintenance to encourage a native landscape. All other areas will be maintained monthly. Scope of maintenance includes mowing, weeding, mulching at least once per year, irrigation maintained as needed, and plant replacement as needed.

LIMITED MAINTENANCE - These areas may be adjacent to a pump station or other improvements. These areas may be bush hogged and or cleared of limbs or debris as needed by the Master Home Owners Association.

REVEGETATED AREAS - These areas may have been partially cleared and or graded during development. It is the intent that these return to a natural state and as such they will receive little or no maintenance.

NATURAL AREAS - These are non-maintained areas to be left in their natural state. They are primarily wooded areas. Open meadow areas within this zone will be left undisturbed to allow successional regrowth that will eventually become wooded. The Master Home Owners Association may choose to plant seedlings in these areas to facilitate this process.

DETENTION BASIN - The detention pond may need to be cleaned out occasionally but the edges around the pond are intended to be left to grow in a natural unmaintained and or wetland environment. However, some of the more visible edged may be maintained to a higher degree by the Master Home Owners Association.

SUPPLEMENTAL HOMEOWNERS MAINTENANCE AREA - This area to be maintained by a Supplemental Home Owners Association for this neighborhood.

HOMEOWNER MAINTENANCE AREA - The right-of-way area between the curb and the front property line and or the curb and the side property line is to be maintained weekly by the home owner whose property faces or sides on the curb. This includes mowing of grass, and maintenance and/or replacement of street trees. (see Typical Right Of Way Maintenance Detail).

ADDITIONAL HOMEOWNERS MAINTENANCE AREA - There are several areas providing access to open space. These areas are not all shown on this plan. These may be located adjacent to one or more private lots. It is the responsibility of the adjacent lot owner(s) to maintain this area on a weekly basis. Maintenance will include mowing and other typical residential yard maintenance actions. (See Typical Access Area Maintenance Detail).

May, 2007: All plans are subject to change.

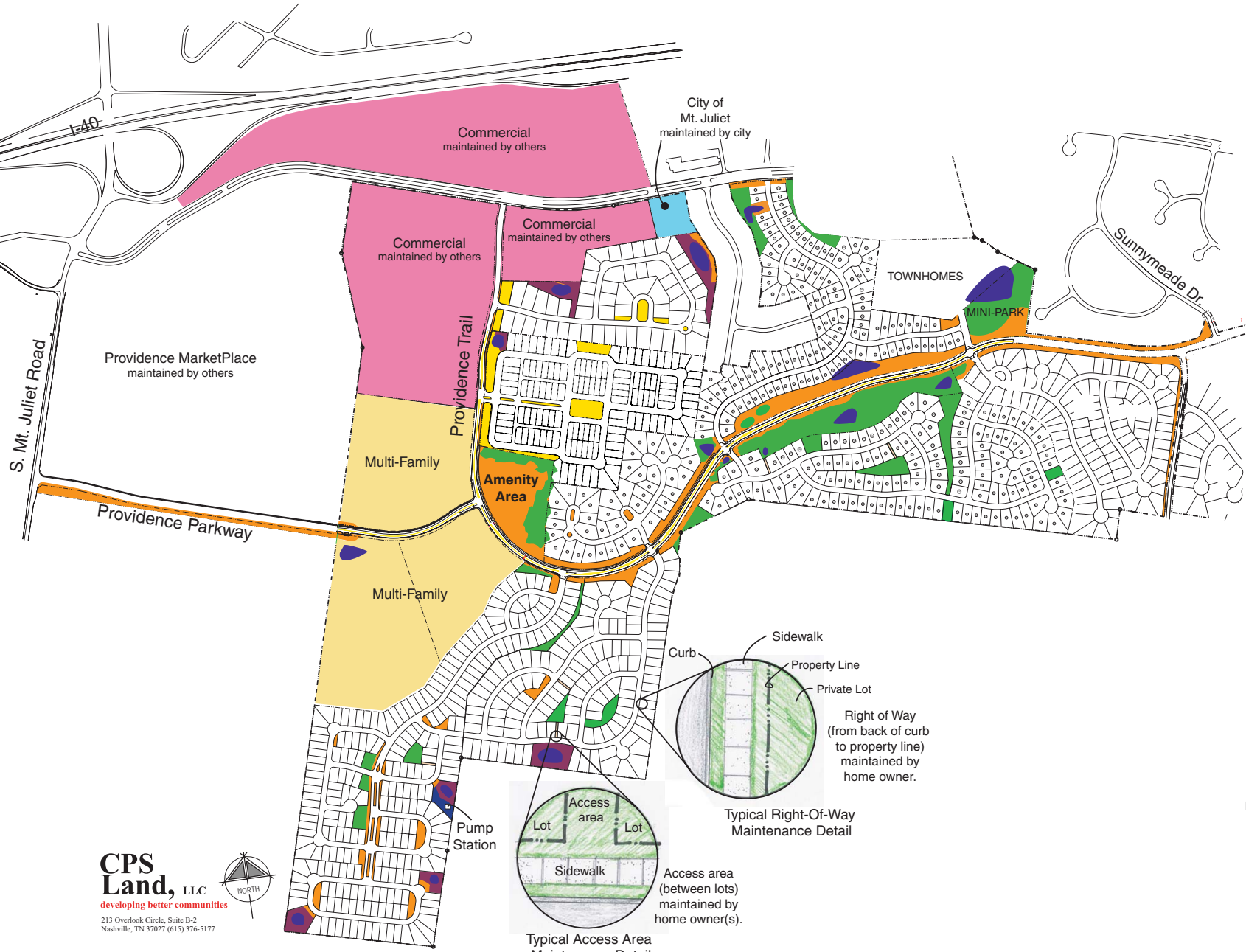

City of Mt. Juliet maintained by city

Providence MarketPlace maintained by others

Commercial maintained by others

Commercial maintained by others

TOWNHOMES

MINI-PARK

Multi-Family

Amenity Area

Multi-Family



Right of Way (from back of curb to property line) maintained by home owner.

Typical Right-Of-Way Maintenance Detail

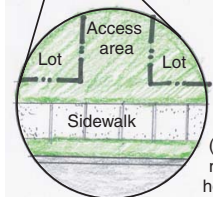

Access area (between lots) maintained by home owner(s).

Typical Access Area Maintenance Detail

Pump Station

CPS Land, LLC
developing better communities
213 Overlook Circle, Suite B-2
Nashville, TN 37027 (615) 376-5177

